

ASSEMBLY INSTRUCTIONS

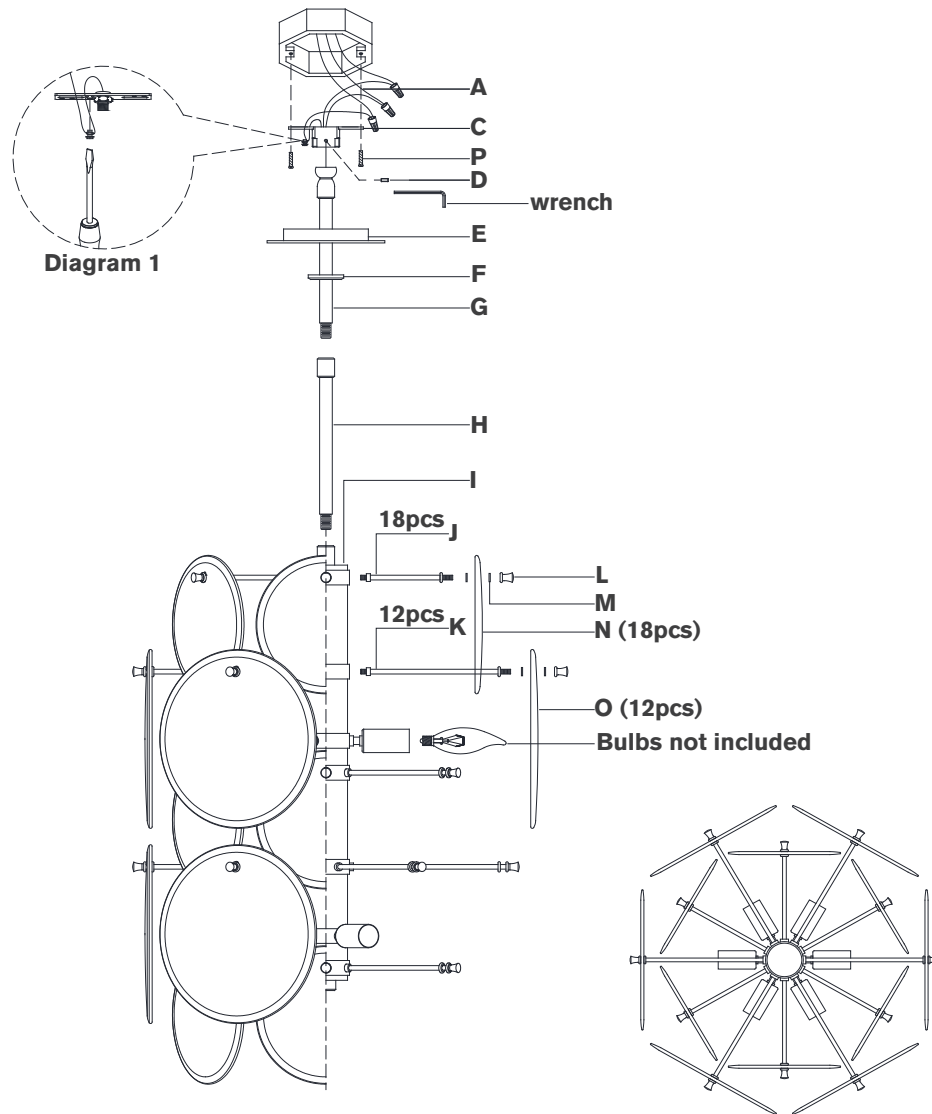

Loire Medium Barrel Chandelier

Item # ARN 5451

NOTICE:

This light fixture should be installed in accordance with all applicable, local installation codes, and by a person familiar with the construction and operation of it, as well as the hazards involved. Inspect item and contents carefully. If any damage or defect is found, do not install. Retain all packaging material until installation is complete and approved.

TOOLS REQUIRED (NOT INCLUDED):

Phillips Screwdriver Slotted Screwdriver Wire Cutters
Wire Strippers

- Carefully remove all parts from the box. Place on a clean, soft surface.
- Remove canopy (**E**) from mounting plate (**C**) by removing collar ring (**F**).
- Feed electrical and ground wires through bottom rod (**H**) and connect to fixture (**I**).
- Continue feeding wires through collar ring (**F**), canopy (**E**) and top rod (**G**).
- Holding fixture upright, slide collar ring (**F**) and canopy (**E**) down and rest on fixture (**I**). Then connect top rod (**G**) to bottom rod (**H**).
NOTE: Slide components down slowly to avoid damages.
- Install mounting plate (**C**) to junction box and secure with mounting screws (**P**).
- Hang fixture to the center of mounting plate (**C**) and secure with set screw (**D**) using provided L-wrench.
- Cut excess wires, being sure to leave enough to reach the junction box.
- Separate two sides of molded wire, and strip insulation on each 5/8".
- Wrap fixture ground wire (bare copper) around the green grounding screw (see diagram 1). Tighten. Continue fixture ground wire and connect to supply ground wire (usually green or bare copper) using wire nut (**A**).

NOTE: It is imperative that the fixture is grounded.

ASSEMBLY INSTRUCTIONS

Loire Medium Barrel Chandelier

Item # ARN 5451

NOTICE:

This light fixture should be installed in accordance with all applicable, local installation codes, and by a person familiar with the construction and operation of it, as well as the hazards involved. Inspect item and contents carefully. If any damage or defect is found, do not install. Retain all packaging material until installation is complete and approved.

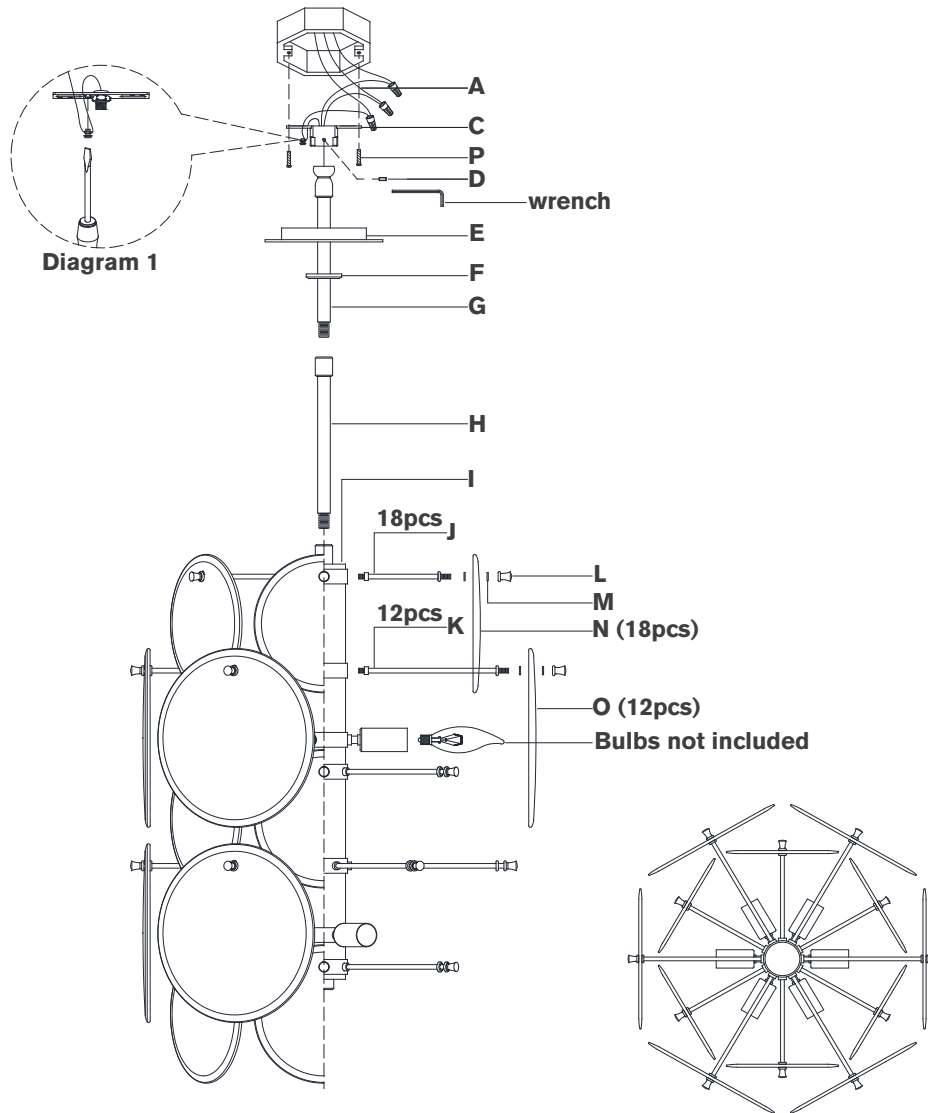

11. Connect fixture neutral wire (ribbed) to the supply neutral wire (usually white) using wire nut **(A)**.
12. Connect fixture hot wire (smooth with markings) to the supply hot wire (usually black) using wire nut **(A)**.
CAUTION: Do not reverse the hot and neutral connections.
13. Make sure all wire connections are tight, then carefully tuck into the junction box.
14. Install canopy **(E)** to mounting plate **(C)** and secure with collar ring **(F)**.
15. Install light bulbs into the sockets.
16. Thread short metal rods **(J)** to the first, third and fifth tier of the center hub.
17. Thread long metal rods **(K)** to the second and fourth tier of the center hub.
18. Loosen finial **(L)** from metal rods **(J)**, attach rubber washer **(M)** to either side of small glass disks **(N)** and secure to metal rods **(J)** with finial **(L)**.
19. Loosen finial **(L)** from metal rods **(K)**, attach rubber washer **(M)** to either side of large glass disks **(O)** and secure to metal rods **(K)** with finial **(L)**.

Care Instructions: Clean only with a soft dry cloth or feather duster. Do Not use abrasive or chemical agents.