

# ASSEMBLY INSTRUCTIONS

## ITEM DESCRIPTION:

ITEM NO.: 49175	NAME: Aaron Sconce
MATERIAL TYPE: Steel	FINISH: Bronze
SOCKET TYPE: E26	SOCKET QTY: 1
BULB WATTAGE: 60W/16W CFL/13W LED	
VOLTAGE: 110-120V	ITEM NET WEIGHT: 5.5LBS

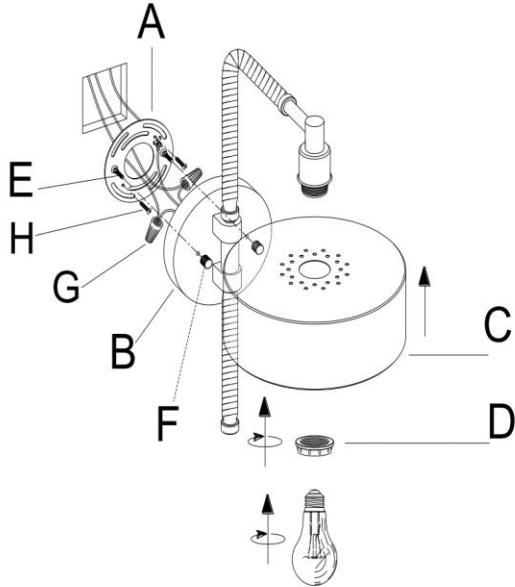

## PARTS INCLUDED:

Mounting Plate ( A )	Qty: 1	Socket Ring ( D )	Qty: 1
Back Plate ( B )	Qty: 1	Threading Pole ( E )	Qty: 2
Shade ( C )	Qty: 1	Mounting Nut ( F )	Qty: 2

## HARDWARE INCLUDED:

Plastic Wire Connector ( G )	Qty: 1
Mounting Screws ( H )	Qty: 2

## TOOLS NEEDED (Not Included):

1 Screwdriver

These instructions are provided for safety. It is very important that they are read carefully and completely before beginning installation.

We strongly suggest that all hard-wired fixtures must be installed by a professional electrician.



## TO ASSEMBLE:

1. Remove all packing contents and parts from the carton(s) carefully.
2. Please be sure you have all parts indicated before you begin assembly.
3. Turn off power to the junction box where the lamp will be installed.
4. Remove the mounting plate (A) from the back plate (B) by loose 2PCS mounting nut (F).
5. Unscrew the socket ring (D) off the socket. Attach shade (C) to the socket and secure with socket ring until tight.
6. Pull the electrical cord of "J Box" through the exit hole of the mounting plate (A).
7. Attach the ground wire from the fixture to the ground junction box wire from the outlet (usually green or bare wire). Fasten each together with a plastic wire connector (G) and wrap the connection with electrical tape. If your outlet box does not have a ground wire, insert the green ground screw into the mounting plate (A) facing down, and wrap the fixture's bare ground wire around the ground screw. IT IS IMPERATIVE THAT THE OUTLET BOX IN YOUR HOME BE PROPERLY GROUNDED.
8. Connect the neutral fixture wire to the neutral junction box wire (usually white). Fasten each together with a wire connector (G) and wrap the connection with electrical tape. Be sure no strands are exposed.
9. Connect the hot fixture wire to the hot junction box wire (usually black). Fasten each together with a plastic wire connector (G) and wrap the connection with electrical tape. Be sure no wire strands are exposed. DO NOT REVERSE HOT AND NEUTRAL CONNECTIONS OR SAFETY WILL BE COMPROMISED.
10. Gently tuck the wire connections neatly into the ceiling junction box.
11. Attach the mounting plate (A) to the outlet box using the mounting screws (H). Tighten with a screwdriver (J).
12. Attach the back plate (B) to the mounting plate (A), and be sure 2PCS threading poles (E) pass through the holes, then use 2PCS mounting nut (F) to tighten until secure.
13. Install one type A 60W bulb (or suitable CFL 16W/LED 13W bulb, not included) into threaded socket. DO NOT EXCEED SPECIFIED WATTAGE.
14. Restore power to the junction box and test fixture.

## CARE INSTRUCTIONS:

Wipe with a soft, dry cloth. To protect finish, avoid the use of chemicals and household cleaners.

For customer service questions call 1-800-338-2150

ARTERIO RS