



DESCRIPTION

Our New Generation of the Reveal, washes the wall from the very top of the ceiling to the floor. Recessed within 5/8" drywall, without the need for joist modification. The 24VDC low-voltage system uses PureEdge's superior designer-grade 95+ CRI LEDs rendering art and color in their truest forms while producing uniform brightness. Simply mount the slim profile, plaster-in extrusions within the profile of 5/8" or thicker drywall 24" away from the projected wall, position our LED soft-strip within the channel, connect to the low voltage power supply then, plaster over the edges and paint to match the surrounding surface. The system is sold in 1' increments up to 20' and can be cut in the field to any length. Continuing to redefine the relationship between lighting and interior design, Reveal Wall Wash invokes dramatic yet refined illumination by highlighting art and creating depth of architectural features. Remote Power Supply is required and ordered separately. Coordinate installation with electrician and drywall contractors. Includes a 5 year pro-rated warranty. For custom quotes, email our design team: design@PureEdgeLighting.com.

DESIGN NOTE

Reveal Wall Wash is an ideal wall washing solution for any space, highlighting art and creating depth within architectural features. Multiple runs of channel mount seamlessly together and may wrap inside corners to wash surrounding walls with uniform controlled illumination up to 95+ CRI.

FINISHES



Satin Aluminum
SA

White
WH

LAMPING

- Choose from multiple standard Color Temperatures including Warm Dim (**27D and 30D**). For Tunable white and RGB/RGBW see other specification sheets.
- 5, 7 or 10 watts per foot
- 50,000 Hour Lamp Life

REMOTE POWER SUPPLIES*, DIMMERS & CONTROLS (SOLD SEPARATELY)

24VDC, Class 2 wiring

- **UNI Driver: Universal Dimming (TRIAC, ELV, 0-10V)**
- **Electronic Low Voltage (ELV)†** 50W IC or 60W Non-IC (fits inside junction box)
- **Lutron Hi-Lume®**

*In-Wall Mounting and drop ceiling Kits available for select power supplies

†ELV power supplies are not compatible with nLight, use only Universal power supplies

APPLICATIONS

Indoor damp or dry locations only. Reveal Wall Wash is ideal in Residential, Commercial, Retail, and Hospitality Environments.

INCLUDED COMPONENTS

Junction Box, Adjustable Mounting Bars, Reveal Wall Wash Channel(s), Power Feed End Cap, Junction Box Cover, Dead End Cap, Take-Up Box, Drywall Screws, LED Soft Strip, and Lens(es)

COMPLIANCE

ETL, Class 2, Damp Location, Made in USA. **1-hour fire rating uses Two pieces of Type X Gypsum board, for 2-Hour fire rating use Three pieces of Type X Gypsum board.**

PureEdge is the Original Designer of 5/8" Drywall Lighting Products with the Most Experience in the industry.

System	Watts Per Foot	Length in Feet	Color Temperature	Reflector Finish
RVWW2	5WDC	20FT	27K	WH
RVWW2 Reveal Wall Wash	5WDC 4.4 Watts 7WDC 7.5 Watts 10WDC 9.6 Watts	1-20FT 5WDC 1-12FT 7WDC 1-10FT 10WDC	22K 2200K Amber White 24K 2400K Very Warm White 27K 2700K Incandescent White 27D 2700K Warm Dim (5WDC only) 30K 3000K Warm White 30D 3000K Warm Dim (5WDC only) 35K 3500K Neutral White 40K 4000K Cool White	SA Satin Aluminum WH White

PROJECT	FIXTURE TYPE	DATE
---------	--------------	------



REVEAL WALL WASH 2

24VDC, PLASTER-IN LED SYSTEM, STATIC WHITE & WARM DIM



REV 12.08.21

LAMP DATA Lamp Data for Reveal Wall Wash

DESCRIPTION	RVWW																			
	5w (4.4 watts)										7w (7.5 watts)					10w (9.6 watts)				
WATTS PER FOOT	22K 24K 27K 27D* 30K 30D* 35K 40K										22K 24K 27K 30K 35K 40K					22K 24K 27K 30K 35K 40K				
COLOR TEMPERATURE	22K	24K	27K	27D*	30K	30D*	35K	40K	22K	24K	27K	30K	35K	40K	22K	24K	27K	30K	35K	40K
LUMENS PER FOOT (lm/ft)	228	253	278	344	303	344	347	378	372	413	454	496	568	617	482	535	588	642	736	800
LUMENS PER WATT (lm/w)	52	57	63	72	69	72	79	85	51	57	62	68	78	84	50	56	61	67	76	83
CRI	85+	90+	95+	92+	95+	92+	85+	85+	85+	90+	95+	95+	85+	85+	85+	90+	95+	95+	85+	85+

*27D, 30D - Warm Dim 5 Watts Only

96W, 24VDC LOW VOLTAGE WIRE SIZE CHART: 3% VOLTAGE DROP

WIRE LENGTH (FT)	UP TO 33FT	34FT-52FT	53FT-86FT	87FT-130FT
WIRE SIZE	14 AWG	12 AWG	13 AWG	8 AWG
VOLTAGE AT END OF WIRE	23.28VDC	23.29VDC	23.28VDC	23.28VDC

5 WATTS PER FOOT - 22K, 24K, 27K, 27D, 30K, 30D, 35K & 40K		7 WATTS PER FOOT - 22K, 24K, 27K, 30K, 35K & 40K		10 WATTS PER FOOT - 22K, 24K, 27K, 30K, 35K & 40K			
LENGTH IN FEET	WATTS	LENGTH IN FEET	WATTS	LENGTH IN FEET	WATTS		
1	5	11	53	1	8	1	10
2	10	12	58	2	15	2	20
3	16	13	63	3	23	3	30
4	20	14	67	4	30	4	40
5	24	15	72	5	38	5	50
6	29	16	77	6	45	6	60
7	34	17	82	7	53	7	70
8	38	18	87	8	60	8	80
9	43	19	91	9	68	9	90
10	48	20	96	10	75	10	100
				11	83		
				12	90		

LENGTH CHART Actual lengths for Reveal Wall Wash

22K, 24K, 27K, 30K, 35K & 40K						
Nominal Length (Inches)	Total Wattage (5W)	Power Supply	Total Wattage (7W)	Power Supply	Total Wattage (10W)	Power Supply
12	5	PSB-40W-UNI-24VDC	8	PSB-40W-UNI-24VDC	10	PSB-40W-UNI-24VDC
24	10	PSB-40W-UNI-24VDC	15	PSB-40W-UNI-24VDC	20	PSB-40W-UNI-24VDC
36	15	PSB-40W-UNI-24VDC	23	PSB-40W-UNI-24VDC	30	PSB-40W-UNI-24VDC
48	20	PSB-40W-UNI-24VDC	30	PSB-40W-UNI-24VDC	40	PSB-60W-UNI-24VDC
60	25	PSB-40W-UNI-24VDC	38	PSB-40W-UNI-24VDC	50	PSB-60W-UNI-24VDC
72	30	PSB-40W-UNI-24VDC	45	PSB-60W-UNI-24VDC	60	PSB-96W-UNI-24VDC
84	35	PSB-40W-UNI-24VDC	53	PSB-60W-UNI-24VDC	70	PSB-96W-UNI-24VDC
96	40	PSB-60W-UNI-24VDC	60	PSB-96W-UNI-24VDC	80	PSB-96W-UNI-24VDC
108	45	PSB-60W-UNI-24VDC	68	PSB-96W-UNI-24VDC	90	PSB-96W-UNI-24VDC
120	50	PSB-60W-UNI-24VDC	75	PSB-96W-UNI-24VDC	100	PSB-100W-ELV-24VDC
132	55	PSB-60W-UNI-24VDC	83	PSB-96W-UNI-24VDC		
144	60	PSB-96W-UNI-24VDC	90	PSB-96W-UNI-24VDC		
156	65	PSB-96W-UNI-24VDC	98	PSB-100W-ELV-24VDC		
161	67	PSB-96W-UNI-24VDC				
168	70	PSB-96W-UNI-24VDC				
180	75	PSB-96W-UNI-24VDC				
192	80	PSB-96W-UNI-24VDC				
204	85	PSB-96W-UNI-24VDC				
216	90	PSB-96W-UNI-24VDC				
228	95	PSB-96W-UNI-24VDC				
240	100	PSB-100W-ELV-24VDC				

*Maximum Chrome Length **Maximum Shipping Length

LENGTH CHART Actual lengths for Reveal Wall Wash

27D & 30D					
Nominal Length (Inches)	Total Wattage (5W)	Power Supply	Nominal Length (Inches)	Total Wattage (5W)	Power Supply
12	5	PSB-40W-UNI-24VDC	147	61	PSB-96W-UNI-24VDC
27	11	PSB-40W-UNI-24VDC	162	68	PSB-96W-UNI-24VDC
42	18	PSB-40W-UNI-24VDC	177	74	PSB-96W-UNI-24VDC
57	24	PSB-40W-UNI-24VDC	192	80	PSB-96W-UNI-24VDC
72	30	PSB-40W-UNI-24VDC	198	83	PSB-96W-UNI-24VDC
87	36	PSB-40W-UNI-24VDC	207	86	PSB-96W-UNI-24VDC
102	43	PSB-60W-UNI-24VDC	222	93	PSB-96W-UNI-24VDC
117	49	PSB-60W-UNI-24VDC	237	99	PSB-100W-ELV-24VDC
132	55	PSB-60W-UNI-24VDC			

*Maximum Chrome Length **Maximum Shipping Length

PROJECT		FIXTURE TYPE		DATE	
---------	--	--------------	--	------	--

INCLUDED COMPONENTS

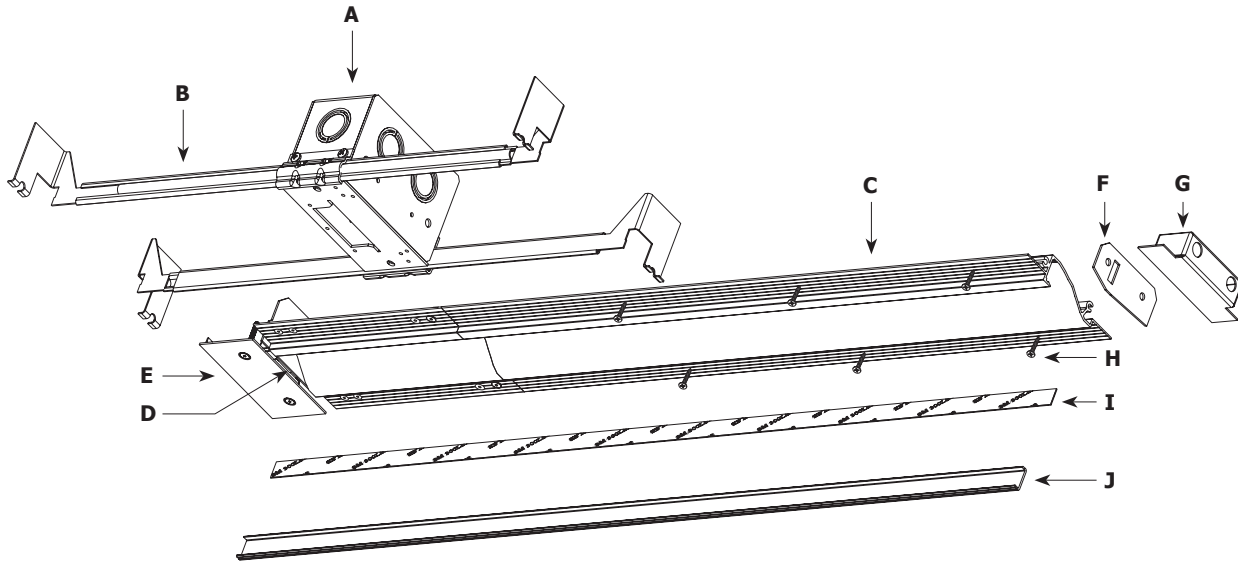

A. JUNCTION BOX

Mounts behind drywall with Adjustable Mounting Bars and includes a drywall template for accurate installation. Low Voltage 24VDC wires from Remote Power Supply connect to LED wires inside box. Junction Box opening is concealed with the Reveal Wall Wash Junction Box cover and is required at the beginning of each run.

B. ADJUSTABLE MOUNTING BARS

Provide flexibility for mounting in a variety of spaces.

C. REVEAL WALL WASH CHANNEL

5/8" deep extrusion houses a single row of Commercial and Designer Grade High CRI 95+ LED Soft Strip.

D. POWER FEED END CAP

Provides a connection area for 24VDC wires at beginning of run where LED Soft Strip enters channel.

E. JUNCTION BOX COVER

Conceals Junction Box opening. Required at the beginning of each run.

F. DEAD END CAP PLATE

Provides a finished look and prevents light leak at feed-end of run where LED Soft Strip exits channel.

G. TAKE-UP BOX

Prevents dark spots at end of run by tucking excess LED Soft Strip safely behind wall.

H. DRYWALL SCREWS

Secure channel to drywall and studs/joists.

I. LED SOFT STRIP

(Back Side shown) Designer Grade High CRI 95+ LEDs Soft Strip. See lamp data on for additional details.

J. LENS

0.74" wide diffused lens projects a clean line of light without LED dots.

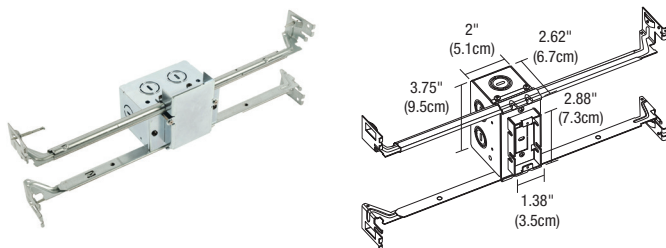

JUNCTION BOX ROUGH-IN COMPONENT

One Junction Box is included with Reveal Wall Wash. Order additional Junction Box separately to rough-in electrical wiring before drywall installation. Quick shipment available.

System	Size	Component
RVWW2	1RE	JBOX
RVWW2 Reveal Wall Wash	1RE 1" Rectangle	JBOX Junction Box

PROJECT	FIXTURE TYPE	DATE
---------	--------------	------

INSTALLATION

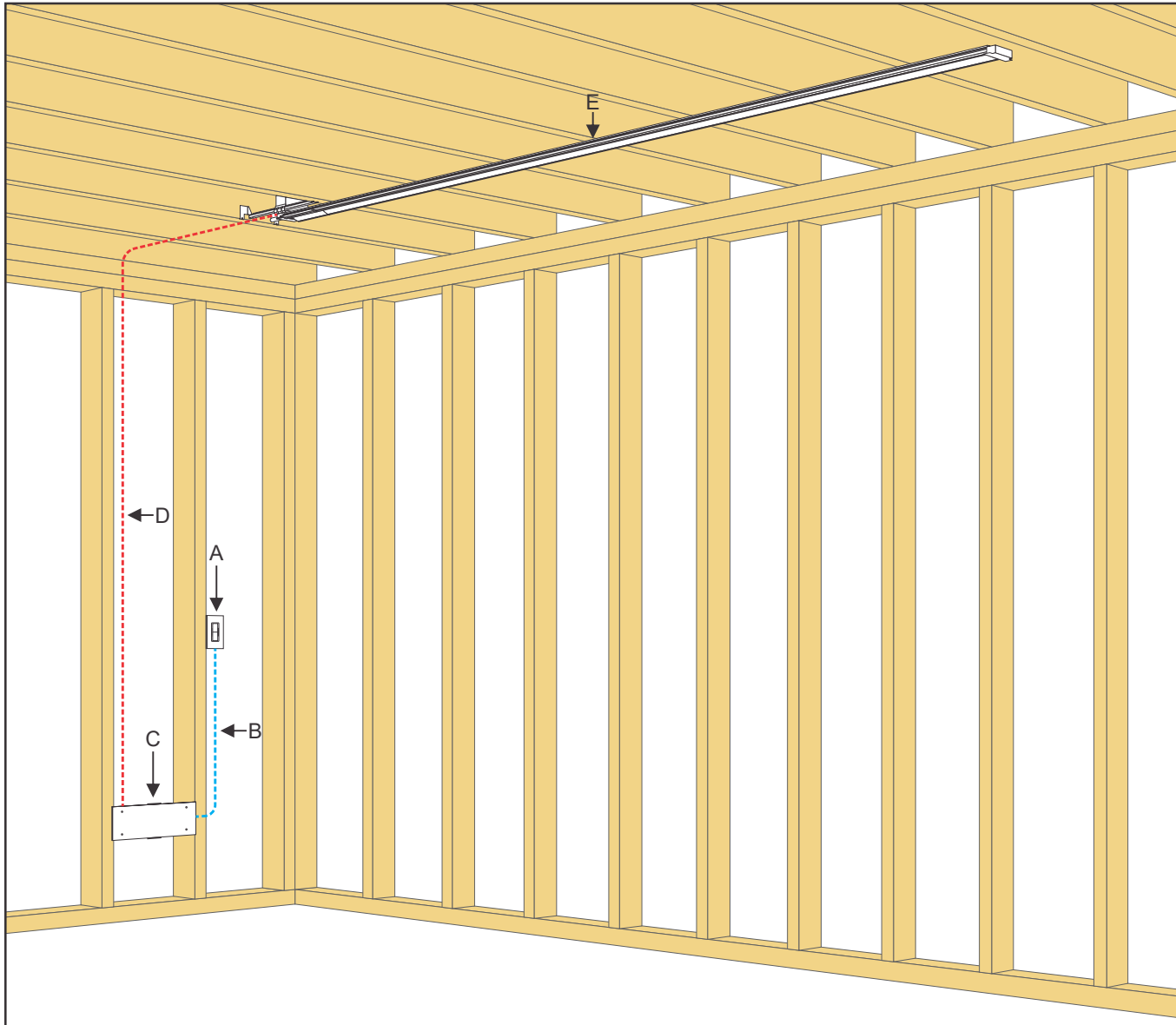

- A. DIMMER OR SWITCH.
- B. 120VAC WIRING TO 120V/24VDC REMOTE POWER SUPPLY, FOR IN-WALL MOUNTING KIT.
- C. IN-WALL MOUNTING KIT.
- D. 24VDC, CLASS 2 WIRING.
- E. REVEAL WALL WASH SYSTEM.

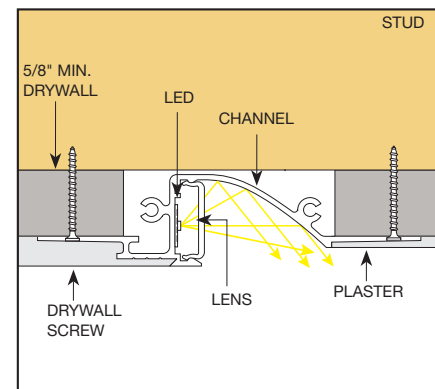

■ Direction of Light

PROJECT	FIXTURE TYPE	DATE
---------	--------------	------

REVEAL WALL WASH 2

24VDC, PLASTER-IN LED SYSTEM, STATIC WHITE & WARM DIM

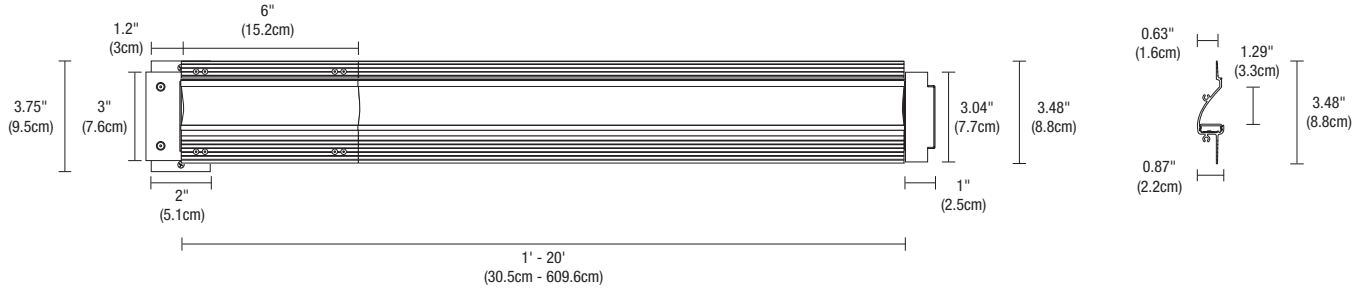

DIRECTION OF LIGHT

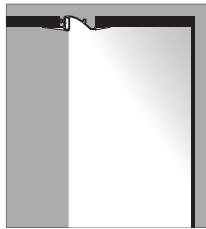

CANDLE POWER DISTRIBUTION

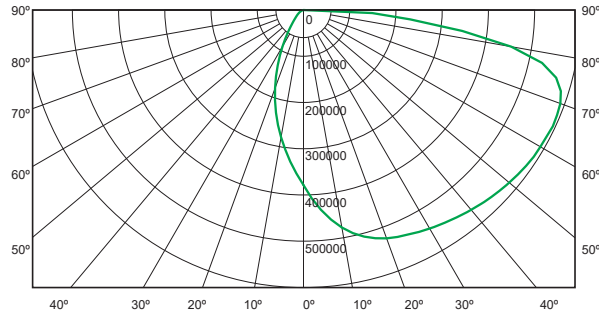

WALL WASH DIRECTION OF LIGHT SHOWN WITH 10 WATT, 3000K VERSION

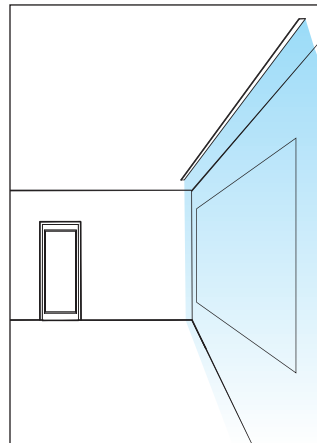

FIXTURE MOUNTED 24" FROM WALL
7W 30K CHANNEL AND DIFFUSED LENS

	1'	2.5'	4'	5.5'	7'
1"	50	50	53	53	43
3"	90	90	104	97	81
6"	113	136	140	137	116
1'	122	138	140	137	113
18"	115	128	128	120	100
2'	100	113	113	109	86
3'	76	89	90	83	67
4'	62	72	70	68	56
5'	50	58	59	55	46
6'	41	46	47	44	38
7'	34	37	38	35	31
8'	27	30	30	30	26
9'	23	25	25	25	21

9' is the ground

PROJECT		FIXTURE TYPE		DATE	
---------	--	--------------	--	------	--

WIRING DIAGRAMS UNIVERSAL POWER SUPPLY

Application: 0-10V dimming for Static White

Dimming: Dimmable with 0-10V dimmer: Philips Sunrise: SR1200ZTUNV; Lutron Diva: DVTV-WH, DVSTV-WH; Lutron Nova T: NTSTV-DV-XX; Lutron Grafix EYE QS: QSGRJ-XP; Lutron Radio Ra2: RRD-10ND; Leviton: LEV40050; Leviton IP710-LFZ; Legrand: ADPD4FBL3P2W4

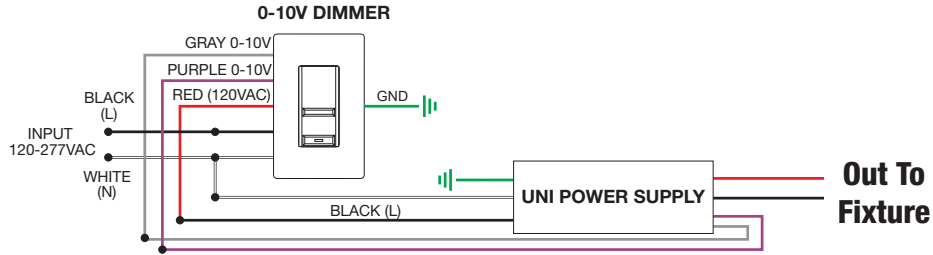

Application: Triac dimming for two power supplies, use for Static White

Dimming: Dimmable with Triac dimmer: Lutron: Skylark S2-L

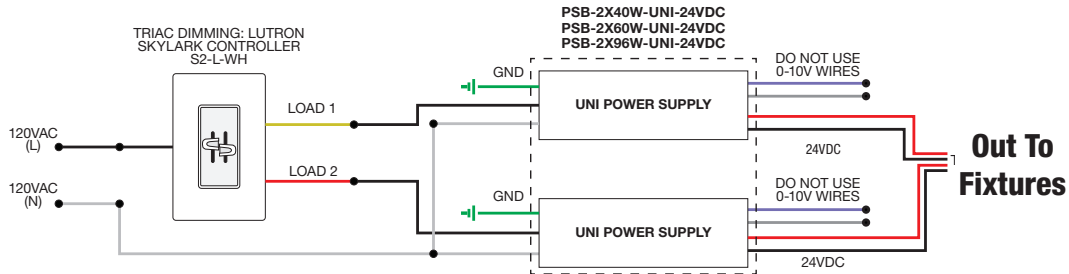

PROJECT		FIXTURE TYPE		DATE	
---------	--	--------------	--	------	--

TM30 DATA

24VDC, PLASTER-IN LED SYSTEM, STATIC WHITE & WARM DIM

TM-30-15 DATA: The data below is for SS2C, SS5C, SS7C, and SS10C bare LED Soft Strips. Consistent color temperatures throughout a single strip and among multiple strips is possible through a 3 phase binning process in which each order is inspected with a color meter to ensure uniformity.

2200K | Rf: 83.9 | Rg: 94.9

Color Vector Graphic

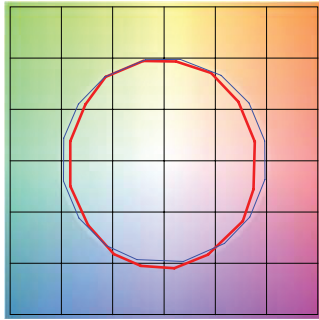

■ Test ■ Reference

HUE BIN	Rf	GRAPHIC SHIFTS %	
		CHROMA	HUE
1	78.8	-9.5%	1.3%
2	80.7	-7.8%	6.7%
3	78.2	-3.3%	9.4%
4	89.7	-2.8%	3.6%
5	93.2	-0.8%	2.6%
6	93.0	-0.6%	-0.7%
7	87.7	-5.9%	-3.5%
8	89.2	-6.8%	1.9%
9	83.4	-5.6%	6.0%
10	79.3	-3.7%	10.8%
11	81.4	2.9%	11.1%
12	84.9	5.3%	4.9%
13	88.1	4.9%	-10.1%
14	68.1	0.1%	-19.5%
15	86.0	-3.3%	-7.3%
16	76.4	-8.9%	-11.7%

2400K | Rf: 84.5 | Rg: 94.4

Color Vector Graphic

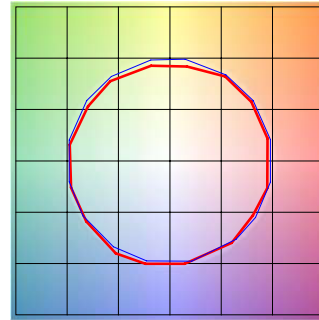

■ Test ■ Reference

HUE BIN	Rf	GRAPHIC SHIFTS %	
		CHROMA	HUE
1	92	-2.4%	1.5%
2	94.7	-2.1%	-0.0%
3	95.4	-1.9%	-0.1%
4	88.7	-6.7%	-3.1%
5	92.8	-5.6%	1.0%
6	92.7	-3.4%	3.4%
7	89.9	-4.3%	4.1%
8	92.4	-1.4%	4.4%
9	89	-0.6%	5.8%
10	88.9	0.4%	6.2%
11	89.7	4.0%	5.4%
12	92.6	3.0%	-0.7%
13	90.9	1.1%	-7.0%
14	89.9	0.5%	-5.8%
15	92.1	-3.2%	0.1%
16	88.9	-1.7%	-6.3%

2700K | Rf: 87.7 | Rg: 96.1

Color Vector Graphic

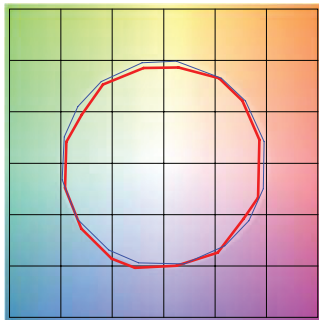

■ Test ■ Reference

HUE BIN	Rf	GRAPHIC SHIFTS %	
		CHROMA	HUE
1	88.0	-4.3%	2.6%
2	91.6	-2.4%	2.0%
3	93.7	-1.4%	1.9%
4	88.9	-5.6%	-3.1%
5	92.3	-5.5%	-0.5%
6	92.9	-3.5%	0.1%
7	84.5	-7.5%	4.6%
8	90.8	-3.0%	4.4%
9	84.5	-1.3%	8.3%
10	83.9	2.0%	9.8%
11	87.2	5.3%	7.1%
12	89.2	5.4%	-2.6%
13	88.7	0.3%	-7.8%
14	86.8	1.7%	-9.3%
15	87.6	-5.4%	-1.3%
16	83.6	-3.3%	-9.5%

3000K | Rf: 88.1 | Rg: 99.7

Color Vector Graphic

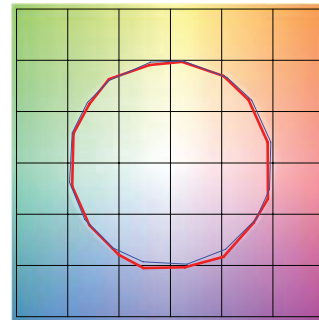

■ Test ■ Reference

HUE BIN	Rf	GRAPHIC SHIFTS %	
		CHROMA	HUE
1	92.5	-3.1%	0.3%
2	93.3	-2.3%	1.9%
3	90.9	-0.8%	3.9%
4	94.3	-1.1%	1.4%
5	92.5	-2.6%	1.5%
6	96.4	1.2%	-0.3%
7	92.6	-2.5%	-0.0%
8	96.9	-1.4%	0.2%
9	92.3	-1.8%	4.3%
10	86.6	-0.7%	7.0%
11	86.5	2.4%	8.2%
12	89.8	5.9%	1.7%
13	93.9	2.6%	-2.7%
14	89.4	5.1%	-5.8%
15	90.1	-0.1%	-4.7%
16	86.5	0.3%	-9.7%

3500K | Rf: 86.1 | Rg: 95.5

Color Vector Graphic

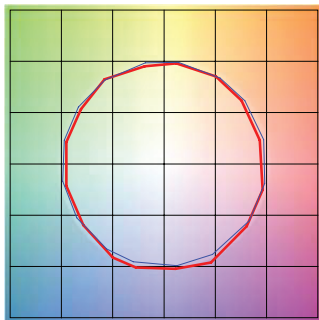

■ Test ■ Reference

HUE BIN	Rf	GRAPHIC SHIFTS %	
		CHROMA	HUE
1	90.8	-3.8%	0.3%
2	92.3	-2.8%	2.1%
3	89.7	-1.0%	4.3%
4	92.6	-1.4%	1.7%
5	91.8	-3.1%	1.3%
6	96.2	0.8%	-0.4%
7	92.9	-3.2%	0.2%
8	94.3	-2.5%	1.5%
9	90.4	-2.5%	5.2%
10	84.3	-1.4%	9.5%
11	83.1	3.5%	9.8%
12	88.2	4.8%	3.4%
13	94.0	2.7%	-2.0%
14	88.7	5.9%	-5.8%
15	88.7	0.7%	-5.9%
16	86.8	-0.7%	-6.7%

4000K | Rf: 87.6 | Rg: 96.8

Color Vector Graphic

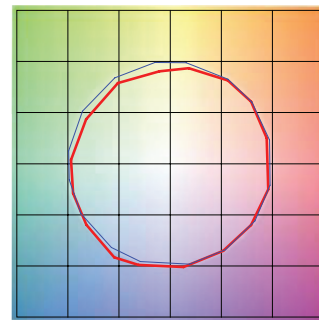

■ Test ■ Reference

HUE BIN	Rf	GRAPHIC SHIFTS %	
		CHROMA	HUE
1	88.9	-2.4%	2.5%
2	93.3	-0.4%	0.8%
3	94.8	-1.0%	-0.6%
4	87.9	-4.9%	-3.6%
5	85.3	-9.4%	-2.6%
6	90.2	-6.0%	0.2%
7	85.3	-7.6%	4.6%
8	83.7	-4.1%	8.2%
9	79.5	-1.1%	13.8%
10	78.6	1.5%	12.1%
11	83.5	6.4%	7.8%
12	90.9	3.6%	-1.1%
13	88.3	1.7%	-6.3%
14	91.9	-0.4%	-2.2%
15	84.5	-0.9%	-5.5%
16	84.7	-1.1%	-4.4%

PROJECT	FIXTURE TYPE	DATE
---------	--------------	------

TM30 DATA

24VDC, PLASTER-IN LED SYSTEM, STATIC WHITE & WARM DIM

TM-30-15 DATA: The data below is for SS2C, SS5C, SS7C, and SS10C bare LED Soft Strips. Consistent color temperatures throughout a single strip and among multiple strips is possible through a 3 phase binning process in which each order is inspected with a color meter to ensure uniformity.

5700K | Rf: 80.3 | Rg: 91.5

Color Vector Graphic

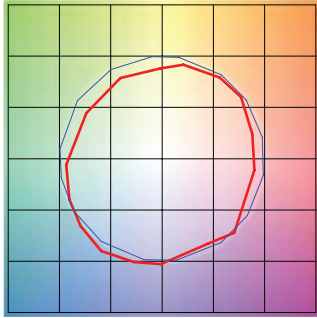

■ Test ■ Reference

GRAPHIC SHIFTS %			
HUE BIN	Rf	CHROMA	HUE
1	75.4	-8.9%	4.7%
2	87.5	-2.6%	4.6%
3	90.7	-3.0%	-0.5%
4	83.2	-6.0%	-5.7%
5	76.2	-12.9%	-5.3%
6	81.4	-11.9%	-2.6%
7	74.8	-14.0%	5.1%
8	69.0	-9.0%	14.1%
9	72.6	-3.6%	22.2%
10	71.4	2.7%	16.1%
11	81.3	7.9%	5.3%
12	83.6	4.1%	-9.4%
13	78.4	0.7%	-15.3%
14	77.7	-6.2%	-11.0%
15	68.8	-1.3%	-21.2%
16	80.8	-9.6%	3.3%

2700D | Rf: 89.5 | Rg: 100.8

Color Vector Graphic

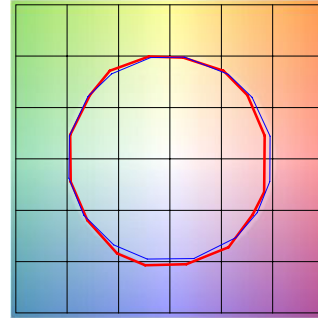

■ Test ■ Reference

GRAPHIC SHIFTS %			
HUE BIN	Rf	CHROMA	HUE
1	88.8	-5.1%	1.4%
2	89.8	-2.7%	4.1%
3	87.2	0.3%	5.9%
4	92.3	-0.9%	1.0%
5	93.3	1.5%	1.7%
6	92.4	3.6%	-0.2%
7	92.2	-0.9%	-2.4%
8	96.7	-0.4%	-1.1%
9	92.3	-1.2%	3.7%
10	88.9	-0.0%	6.1%
11	86.4	5.1%	7.4%
12	88.2	6.3%	-0.9%
13	87.2	3.8%	-8.1%
14	84.2	3.8%	-11.0%
15	89.8	-2.6%	-4.3%
16	82.7	-3.4%	-11.1%

3000D | Rf: 89.8 | Rg: 101.4

Color Vector Graphic

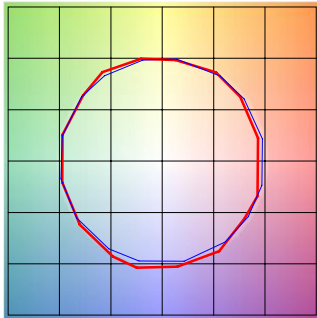

■ Test ■ Reference

GRAPHIC SHIFTS %			
HUE BIN	Rf	CHROMA	HUE
1	90.2	-4.2%	1.5%
2	90.9	-2.0%	3.7%
3	87.9	0.8%	5.5%
4	92.1	-0.9%	0.6%
5	93.0	1.5%	1.6%
6	92.2	3.9%	-0.2%
7	92.1	-0.3%	-2.0%
8	96.7	0.0%	-1.2%
9	92.5	-0.6%	3.7%
10	88.3	1.1%	7.0%
11	87.2	4.1%	7.4%
12	87.2	6.7%	-1.0%
13	88.2	3.8%	-7.2%
14	85.3	4.3%	-9.9%
15	90.9	-2.2%	-3.6%
16	83.4	-2.2%	-11.2%

PROJECT	FIXTURE TYPE	DATE
---------	--------------	------