

## DETAIL KIT / TOGGLE / LINEAR

---

**ACTION: DETAIL KIT**

---

**KNURL: LINEAR**

---

**RANGE: DETAIL KIT**

---

A toggle switch detail kit in our signature Linear knurl, made from solid metal. Combine this detail kit with our toggle modules and wall plates to create a unique custom product or update the aesthetic of an existing modular B+P toggle.

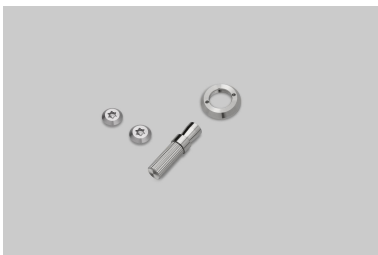
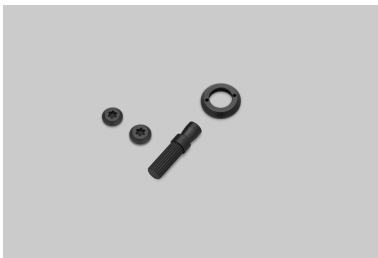
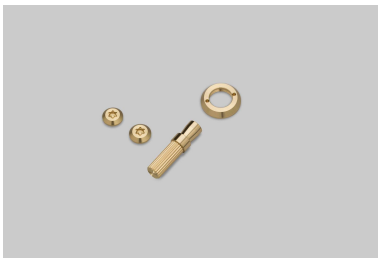

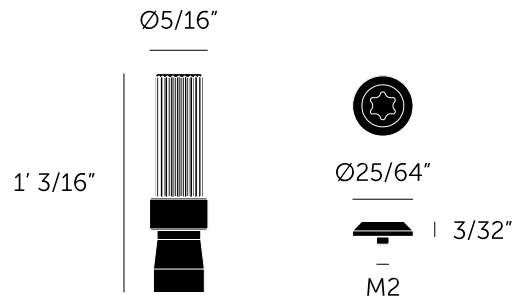

---

#### SPECIFICATIONS

---

A toggle detail kit with torx cap details for use with Buster + Punch switch plates and toggle modules.

---

#### INCLUDED

---

1 x Linear Toggle Arm  
 2 x Torx Caps  
 1 x Detail Kit Multi-tool

---

#### FINISH & SKU NUMBERS

---

sku:	finish:	size:
NTK-024522	● black	1G
NTK-054522	● brass	1G
NTK-454522	● smoked bronze	1G
NTK-074522	● steel	1G
NTK-144522	● white	1G

---

#### PLEASE NOTE

---

DISCLAIMER: Always consult a trade professional when installing this product. Buster + Punch is not responsible for the usage or feasibility of installation requirements. This product is not suitable for damp or wet environments.

---

#### CARE INSTRUCTIONS

---

Wipe with a dry lint free cloth with no loose hairs, avoid using any chemicals. Please note that finishes may age naturally with time and regular use.